



# DESKTOP PILOT

## Instruction Manual for Replacing Knobs with Carburetor Heat Control Knob

After printing the Carb Knob, attach the printed parts using glue and should look like the picture shown.



From your throttle box, start by unscrewing the screws on the corners of the throttle box.



You need to loosen the set screw located underneath the knobs of the throttle box using a 1.5mm hex key and rotating it counterclockwise and then removing the knobs of the throttle box. (Careful not to loosen too much and lose the set screw)

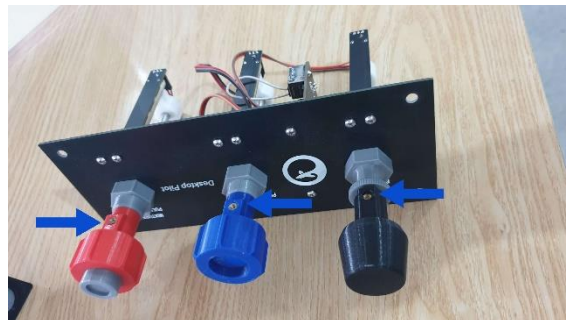



# DESKTOP PILOT

After removing the knobs, you will notice screws at the back of the black panel board. These screws are for the guides of each knob. You will then need to unscrew the screws of the middle guide and the throttle guide to exchange them at the front and then screw it again in place.

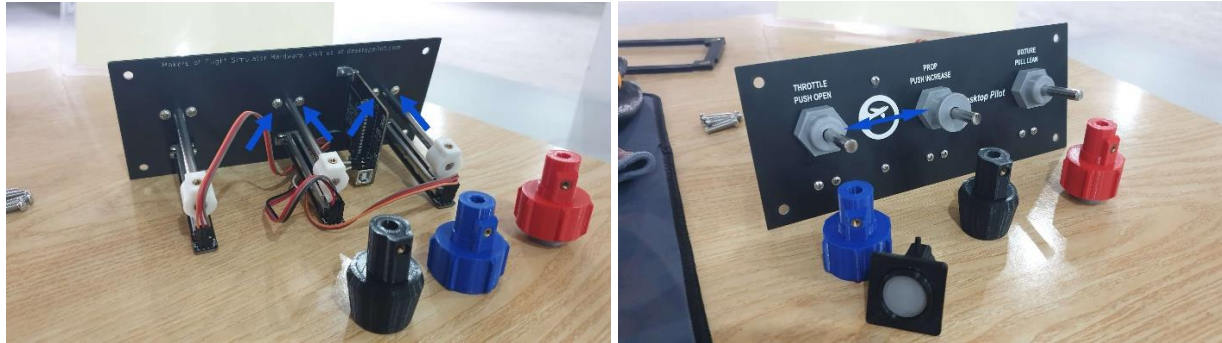

Place your desired knobs on the new design of throttles. For realistic design, place the Carb Knob on the left rod, Throttle Knob on the middle, and Mixture Knob on the right rod and then tightening the set screw to make the knobs stick in place. (Make sure the set screws are facing downwards)

At the back of the product, you will see the slide mount where you can adjust it to your desired location by loosening the set screw using a 1.5mm hex key and then tightening it to your preferred location using the same hex key. (Make sure the Carb Knob is sticking on the guide)

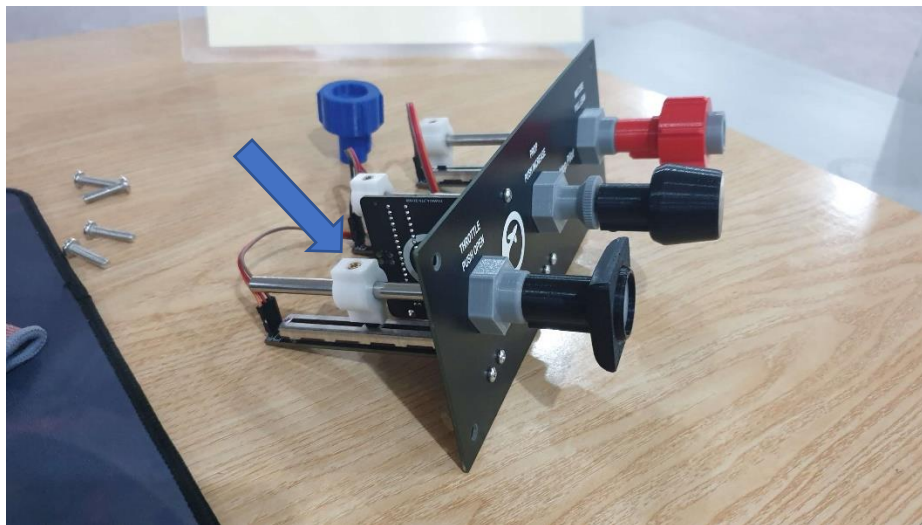

Finally, bring back the box of the throttle and then screw it back together.